

DWARKA PROJECT

AREA STATEMENT

TOTAL AREA OF THE SITE - 8159.01 Sq.m.

PLOT NO.	FACILITIES	PROP. AREA
1	PRIMARY SCHOOL	4013.52 Sq.mt.
2	CON. SHOPPING	1202.13 Sq.mt.
3	BANQUET HALL	1677.76 Sq.mt.
4	DISPENSARY	925.60 Sq.mt.
5	RELIGIOUS	350.00 Sq.mt.

NOTES

GRD. COVERAGE, F.A.R., MAX. HEIGHT AS PER M.P.D. 2001

1 REVISED LAYOUT PLAN APPROVED BY COMMISSIONER - PLG ON PG.13N IN FILE NO. F8(22)/96-HAF/DWK
 2 THIS LAYOUT PLAN SUPERSEDES THE EARLIER PLAN APPROVED BY V.C. D.D.A. ON PG.12N IN FILE NO. F8(10)/94/DWK./HAF-B/PT-I DT. 13/11/96

3 FEASIBILITY REPORT RECEIVED FROM EX-ENGR./3WD G/D.D.A. VIDE LETTER NO. F1(14)/AE III/SWD G/D.D.A./97-98/1369 DATED 12/7/99. AND INCORPORATED IN THE DRG.

4. NUMBERING OF PLOTS APPROVED BY DIR.(Plg)DWK ON PAGE NO 15 N IN FILE NO- F8(22)/96/HAF DWK. Dtd. 18.10.99.

- 1 THE PLAN IS SUBJECT TO MODIFICATIONS WITHIN THE FRAMEWORK OF MASTER PLAN/ZONAL PLAN.
- 2 IT IS FOR PLANNING PURPOSE & IS NOT FIT TO BE PRODUCED IN THE COURT OF LAW FOR PROPERTY DISPUTES.
- 3 ALL THE DIMENSIONS & AREA GIVEN IN THE PLAN ARE SUBJECT TO CONFIRM OF OWNERSHIP/ALLOTMENT STATUS & DEMARICATIONS/FEASIBILITY REPORT FROM THE DDA LANDS & ENGINEERING WING RESPECTIVELY.

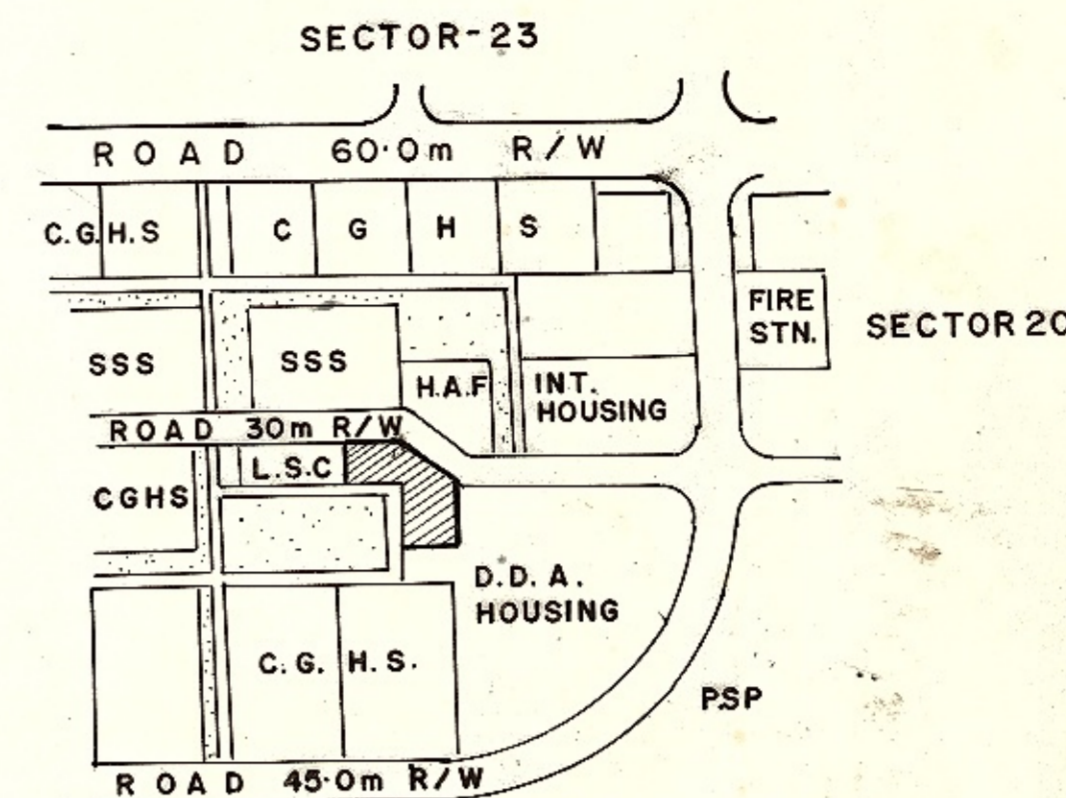

KEY PLAN
SCALE 1:8000

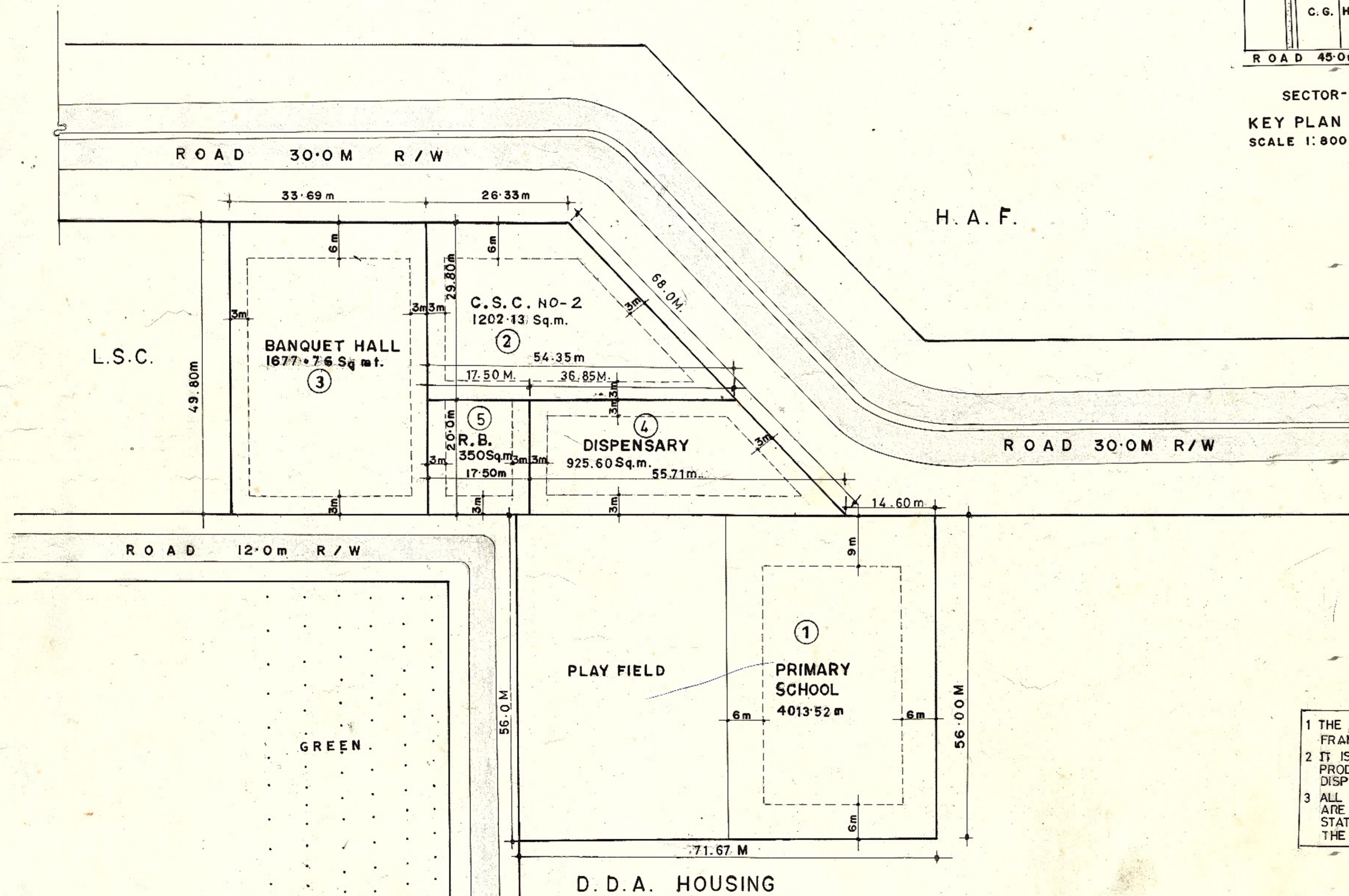

PKT. B (REVISED)

HOUSING AREA FACILITY SECTOR 22

1:500 SCALE		DPA/DWK/LOP(REVISED)/HAF PR: b/SEC 22/99/10 DRG.NO
PLG. D / MAN	PLG. ASSTT.	DATE
ASSTT. DIRECTOR	JT. DIRECTOR	DIRECTOR